

T-Intersection Pop-Out at Olive & Maroa

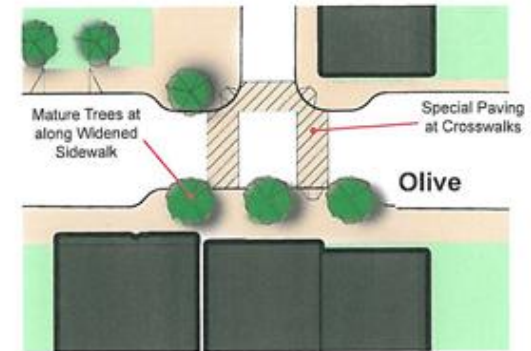

Traffic Circle at Olive & Van Ness



These three simple plan views show the essence of the concept clearly!



Widened sidewalk at Broadway & Olive, showing a typical sidewalk cafe



Plaza at the northeast corner of Olive & Wishon, showing a kiosk, sitting blocks & wall, and street furniture



Top plan uses numbers to refer to vignette drawings (vignettes are little-quick sketch drawings that help show what you're thinking, they don't have to be perfect - they just need to get the idea across !!)



Figure E-2.2x: Existing Site-Specific Streetscape Improvement Project at Hoff and 16th Streets- Looking South.



Nice simple overlay technique that shows the designers ideas to add planting beds, trees, sidewalk markers, etc !!



Google Earth aerial picture (anybody can download these), simply rendered to show the designer's "big ideas".



Kennedy & Montgomery Streetscape Concept

Nice plan view (right) and vignette (above) that show what this designer wants to do with the beginning of Kennedy Ave to give more "announcement" to its entrance (notice what a large statement small wispy yellow and red banners make!).

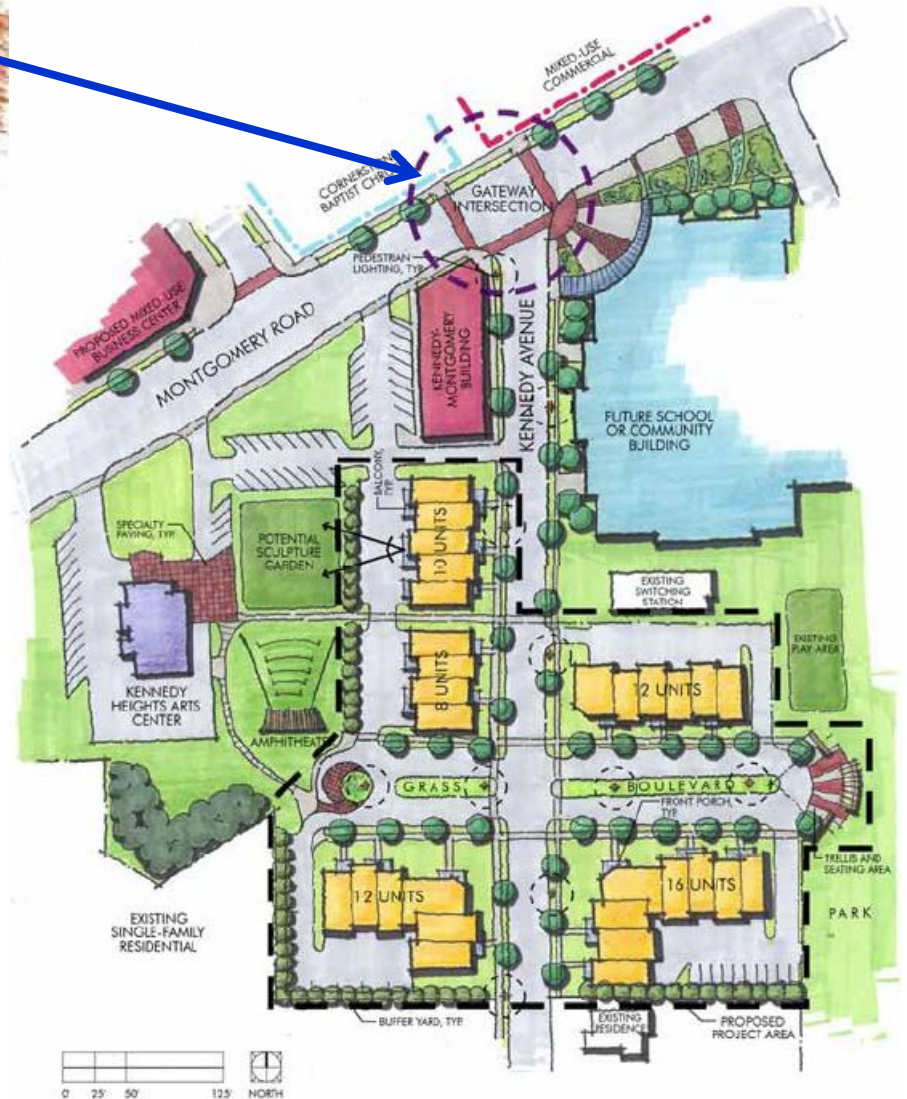



More examples, look at what happened to the building on the right. Small things (windows and awnings) can make a big difference!